

# TYPE EVT-300E

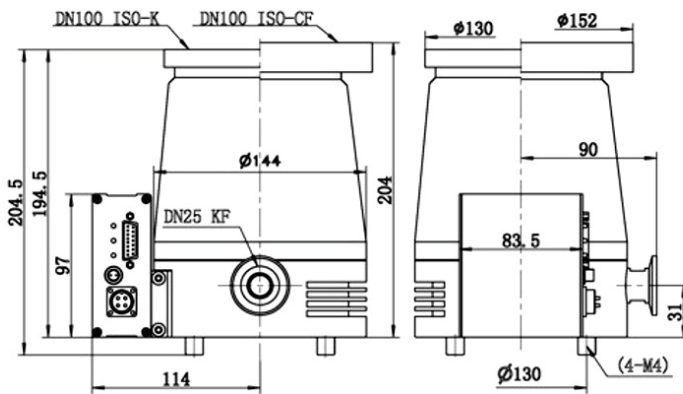
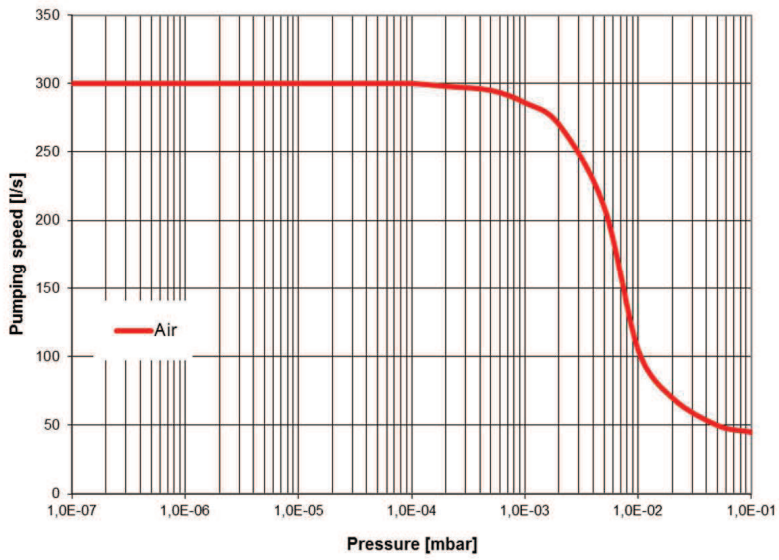

## TYPE EVT-300E

Technical Data		TYPE EVT-300E	
		300E-LF	300E-CF
Pump type		Compound/Drag	Compound/Drag
Inlet Flange		100 ISO-K	100 CF
Fore vacuum Flange		25 KF	25 KF
Pumping speed (Air)	l/s	300	300
Fore vacuum max.	mbar	5	5
Rotation Speed	rpm	60.000	60.000
H <sub>2</sub> Compression Ratio		> 5x10 <sup>5</sup>	> 5x10 <sup>5</sup>
N <sub>2</sub> Compression Ratio		> 6x10 <sup>8</sup>	> 6x10 <sup>8</sup>
Ultimate Vacuum	mbar	< 6x10 <sup>-8</sup>	< 6x10 <sup>-9</sup>
Run up Time	min	< 3,5	< 3,5
Control Unit		TC100 / TCP100	TC100 / TCP100
Input Voltage		24VDC / 100W	24VDC / 100W
Cooling medium		Air (water option)	Air (water option)
Vibration	µm	< 0,1	< 0,1
Bearing type		Ceramic Grease	Ceramic Grease
Operating Orientation		Any	Any
Weight Pump/Controller	kg	8,5 / 1,0	11,0 / 1,0
Communication modul		RS-232 (RS-485)	RS-232 (RS-485)
Controller dimensions l <sub>w</sub> xh	mm	135x130x70	135x130x70

Ordering Information	TYPE EVT-300E	
	300E-LF	300E-CF
<b>Turbo drag pump EVT-300E</b> excl. control unit & cable	803002	803003
TC-100 onboard controller	800042	
TCP-100 controller and power supply	800041	
Controller cable 2,5 m	801011	
Controller cable 5 m	801012	
Recommended pre-vacuum pump: Standard operation Type EVD-12, 230V AC	421901	
Purge gas operation Type EVD-24, 230V AC	422901	